

Overview

Fujitsu fi-7300NX Network Document Scanner

Fujitsu

Part no. FJ3164



Price

A\$ 1899 (incl. GST)

A\$ 1726.36 (excl. GST)

Availability: Available

Part no. FJ3164
% A\$2,309.00* (17.76% saved)

Prices incl. VAT plus shipping costs

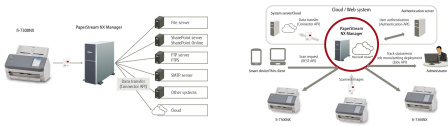

28.11.2021

* All prices incl. VAT plus shipping costs and possible delivery charges, if not stated otherwise.

Description

A gateway to flexible, centralised capture, the Fujitsu fi-7300NX network scanner boasts a speed of 60 ppm/120 ipm (200/300 dpi) for scanning A4 portraits, loads up to 80 sheets at a time, and supports 5 GHz Wi-Fi.

You can initiate a scan from the scanner with touch screen or smart device operation. Various authentication methods are supported.

Important note : unlike the Fujitsu N7100 which is a fully stand-alone network scanner, the fi-7300NX does rely upon the installation of software on a server. While they may look similar at first glance, those products are in fact significantly different and we encourage you to compare their features to find out which one will best suit your business.

Product information

Model No.:	fi-7300NX
ADF Capacity (pages):	80
ADF Scan Area - Max.:	216x355 mm
ADF Scan Area - Min.:	51x54 mm
Duplex or Simplex:	True Duplex
ADF Speed (ppm):	60
ADF Speed Duplex (ipm):	120
ADF Paper Path:	Straight
Paper Weight:	27 to 413 gsm
Colour Modes:	B&W, Greyscale, Colour
Scanning Technology:	CIS x 2
Interface:	Ethernet, Wi-Fi 2.4 / 5 GHz, USB3
Resolution (dpi, optical):	600
Light Source:	LED
File Formats:	PDF, JPEG
Software Standards:	Network and communication protocols:TCPIP DHCP, ICMP, UDP, HTTP/HTTPS, DNS
Imaging Features:	Auto deskew, auto orientation, auto page size detection and blank page detection
PC Configuration:	Network with Windows Server required
Supported OS:	Windows Win7, Win 10, Server 2008, Server 2012, Server 2018 (Refer to Operator's Guide for server requirements)
Dimensions:	300x202x170 mm
Weight:	4.9

Electrical:	Input: 100-240 VAC, 50/60 Hz. Power consumption:
Operating Environment:	5°C to 35°C, 20-80%RH
Warranty:	12 months parts & labour warranty
ADF (Doc. Feeder):	Yes
Duty Cycle:	★ ★

Reviews

0 of 0 reviews



No reviews found. Be the first to share your insights.